

RFB4E Floor Box with Evolution Series Cover

### Recessed Floor Boxes for Concrete Floors

Resource RFB® E Series Floor Boxes are versatile recessed activation solutions that provide power, communication and/or A/V services to open space areas, or directly to workstations. Resource RFB E Series Floor Boxes are available in two- to six-gang models with a variety of aesthetic cover options including colors and profiles available.

Resource RFB E Series Floor Boxes have many applications, including schools, financial institutions, commercial office buildings, and hospitality.

**PRODUCTS: RFB2E, RFB2E-0G, RFB4E, RFB4E-0G, RFB6E, RFB6E-0G**

### Features & Benefits

- **Installs in bare concrete and terrazzo floors.** By using bare floor and terrazzo rings (sold separately) these boxes can be installed in bare concrete or terrazzo floors with a clean, aesthetic finish.
- **Lightweight “slab-on-grade” version.** Special fusion-bonded epoxy corrosion resistant paint finish allows for slab-on-grade use without the weight of cast iron material.
- **Fully adjustable before and after the concrete pour.** Labor savings by adapting to various pour depths and conditions.
- **Range of conduit sizes.** Standard box allows for most conduit schemes, even feed-through capability, which saves time and money during installation. KOs range from 3/4” to 1 1/4” trade size.
- **2” Conduit Hub.** By using 2HUB (sold separately) with the RFB2E, RFB4E & RFB6E Floor Boxes, a greater capacity of pre-terminated cables can be brought into the shallower box increasing functionality and reducing concrete pours.
- **Triple service boxes.** Accommodates power, communication and/or audio/video devices which reduces the need for multiple boxes.
- **Uses Evolution Series Round Activation Covers.** Provides TopGuard protection from water, dirt and debris plus added strength and durability. Now available in seven decorative finishes: Brushed Aluminum and Black, Brass, Nickel, Gray, Bronze and Aluminum powder coats for carpet, tile and furniture feed versions.
- **Wide variety of device mounting brackets.** Can adapt to most power and communication needs. Reduces overall life cycle cost.
- **Datacom connectivity options.** Accepts industry standard and proprietary devices from a wide range of manufacturers to provide a seamless and aesthetically pleasing interface for voice, data, audio, and video applications at the point-of-use. A wide selection of data and adapter options are available for use with Ortronics TracJack and Series II devices.
- **NAFTA versions.** Evolution Series Covers are now available in versions that meet NAFTA requirements.

### Vertical Markets

- Commercial
- Healthcare
- Hospitality
- Education
- Retail
- Financial



Download this product's PEP ecopassport® environmental product declaration at [www.legrand.us/resources-and-downloads](http://www.legrand.us/resources-and-downloads). This declaration conforms with ISO 14025 and 14040 and is in alignment with EN 15804.

### Compliance



cULus Listed Metallic Outlet Boxes for tile, terrazzo, carpet and wood floors. File E2961 Guide QCIT/7.



Protection from water, dirt, and debris.

**RFB Series Floor Boxes with Round Activations Selection Guide**

Box Model	Install Floor Type:		Box Type:	Box Capacity:	Depth Behind Plates:	A/V Compatibility	Trade Size Conduit Feed:	Cover Style	Country of Origin	Adjustability
	Concrete	Wood								
RFB2E	Yes	No	Above Grade	2 Gangs	3 1/2" (89mm)	Legrand AVIP, Altinex, Intera, Extron AAP, MAAP & Decorator, Ortronics Series II	3/4" - 2"	Evolution 6CT2, 6CTC2 & 6CFFTC Series	Mexico	Fully Adjustable
RFB2E-OG	Yes	No	On-Grade	2 Gangs	3 1/2" (89mm)		3/4" - 2"		Mexico	
RFB4E	Yes	No	Above Grade	4 Gangs	3 1/2" (89mm)		3/4" - 2"		Mexico	
RFB4E-OG	Yes	No	On-Grade	4 Gangs	3 1/2" (89mm)		3/4" - 2"		Mexico	
RFB6E	Yes	No	Above Grade	6 Gangs	3 1/4" (83mm)		3/4" - 2"	Evolution 8CT2 & 8CTC2 Series	Mexico	
RFB6E-OG	Yes	No	On-Grade	6 Gangs	3 1/4" (83mm)		3/4" - 2"		Mexico	

**NOTE:** Pricing may vary depending on country of origin. Consult your local sales representative for more information.

### RFB2E Series Floor Boxes Ordering Information

#### RFB2E

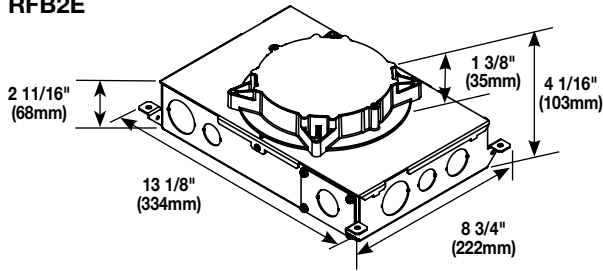

**Two-Compartment Floor Box** – For use in concrete floors. For use with round Evolution covers. Fully configurable with removable dividers. Device plates sold separately.

Country of Origin: Mexico

#### RFB2E-OG

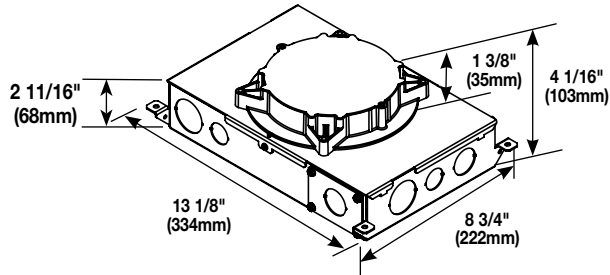

**Two-Compartment On-Grade Floor Box** – For use in concrete floors. For use with round Evolution covers. Fully configurable with removable dividers. Device plates sold separately.

**NOTE:** RFB2E-OG for on-grade applications is painted with a fusion-bonded epoxy designed for use on metal reinforcement bar and related accessories before encapsulating in concrete.

Country of Origin: Mexico

### RFB2E Series Floor Boxes Compartment Capacities/Knockout Locations & Sizes

RFB2E & RFB2E-OG COMPARTMENT CAPACITIES	
EACH COMPARTMENT	70 in. <sup>3</sup> (1147ml.)

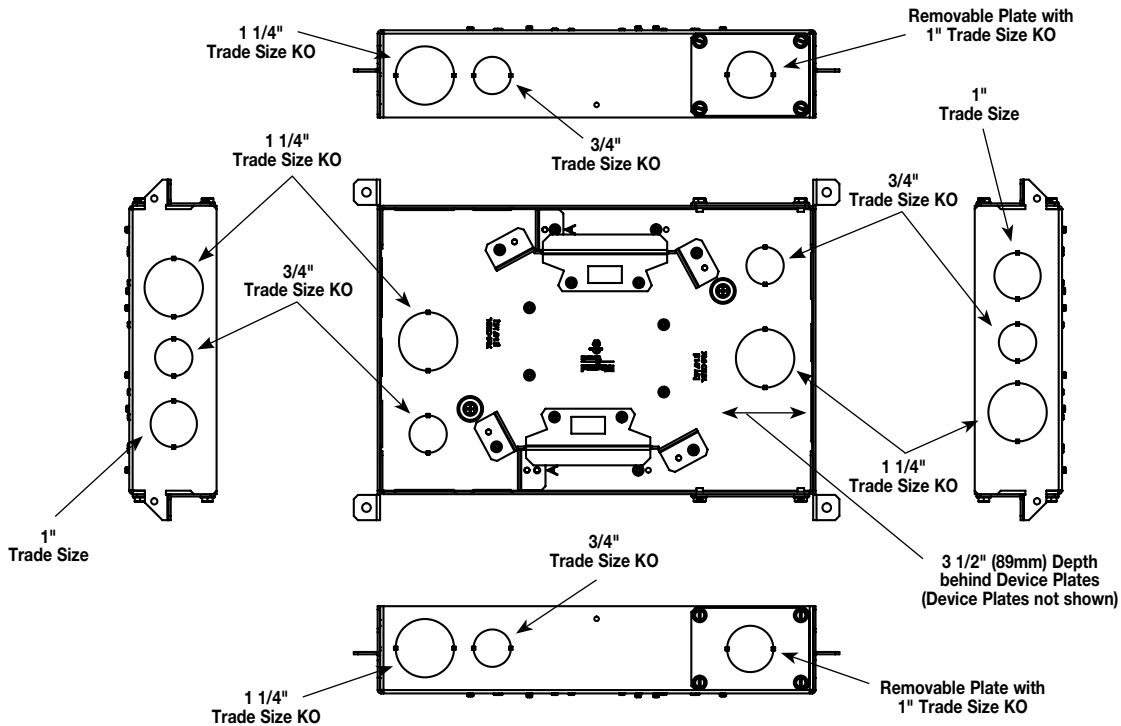

**RFB2E, RFB2E-0G Series Floor Box Accessories Ordering Information**

**RFB4EKIT**

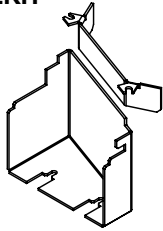

**Barrier Kit** – Barrier kit used to separate power and communication services in combination with a 6CFFTC Furniture Feed Cover (sold separately).

**Country of Origin: Mexico**

**RFB6EXT**

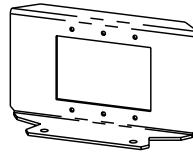

**Internal Audio/Video Bracket** – Accepts three (3) Legrand AVIP or Extron Electronics MAAP Series devices (sold separately).

**Country of Origin: USA**

**RFB6DP**

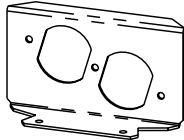

**Internal Duplex Receptacle Bracket** – Accepts standard 15 & 20 Amp duplex receptacles.

**Country of Origin: USA**

**RFB62A**

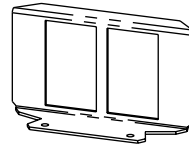

**Internal Communication Bracket** – Includes two (2) adapters to accept Wiremold CM2 Series Open System communication inserts (sold separately).

**Country of Origin: USA**

**RFB6B**

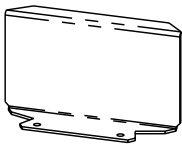

**Internal Blank Bracket** – Closes off unused gangs.

**Country of Origin: USA**

**RFB6-AAP**

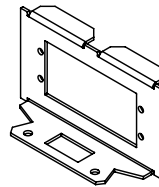

**Internal Audio/Video Bracket** – Accepts two (2) Extron Electronics AAP Series devices (sold separately).

**Country of Origin: USA**

**RFB6GFI**

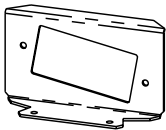

**Internal GFI or Decorator Style Receptacle Bracket** – Accepts standard GFCI & Decorator style receptacles, communication or A/V devices.

**Country of Origin: USA**

**2HUB**

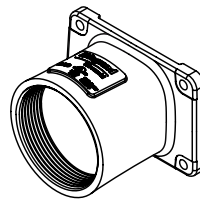

**2" Conduit Transition Hub** – Trade size 2" die cast zinc conduit fitting allows for 2" conduit to transition into a shallow box design. Includes: die cast fitting, gasket, and mounting screws.

**Country of Origin: USA**

**RFB6S1**

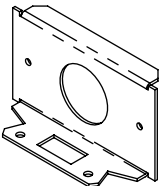

**Internal Single Receptacle Bracket** – Receptacle opening 1 3/8" (35mm).

**Country of Origin: USA**

**RFB4E-CTR**

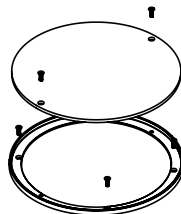

**Bare Concrete & Terrazzo Ring** – Nonmetallic ring for use with bare concrete and terrazzo floor applications.

**Country of Origin: USA**

**RFB6S2**

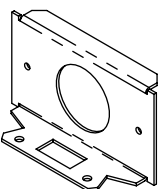

**Internal Single Receptacle Bracket** – Receptacle opening 1 9/16" (40mm).

**Country of Origin: USA**

**6TS**

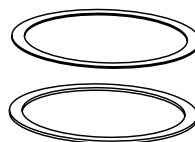

**Tile Shim** – Used for floor coverings greater than 5/16" (7.9mm). The 6TS will allow the top surface of the cover to be flush with the finished floor. Includes: six (6) 1/16" (1.6mm) thick shims. Up to a total of 3/8" (9.5mm) of adjustment, per pack of tile shims.

**Country of Origin: USA**

**RFB6RT**

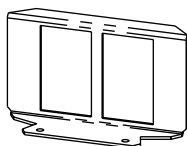

**Internal Communication Bracket** – Includes two (2) adapters to accept Ortronics TracJack devices, and two (2) adapters to accept Ortronics Series II devices (sold separately).

**Country of Origin: USA**

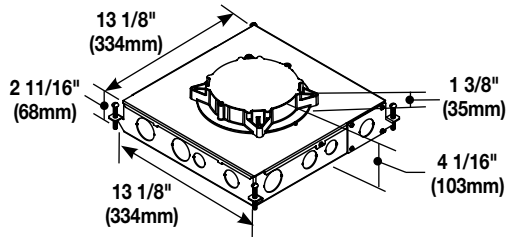
**RFB4E, RFB4E-OG Floor Box Ordering Information**
**RFB4E**

**Four-Compartment Floor Box** – For use in concrete floors. For use with the round Evolution cover. Fully adjustable with tunnel compartments. Device Plates sold separately.

Country of Origin: Mexico

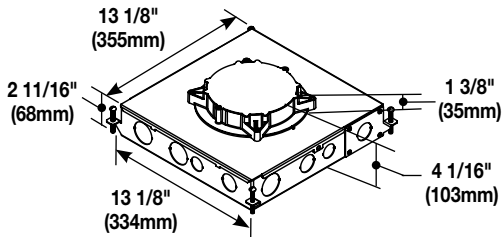
**RFB4E-OG**

**Four-Compartment On-Grade Floor Box** – For use in concrete floors. For use with the round Evolution cover. Fully adjustable with tunnel compartments. Device Plates sold separately.

Country of Origin: Mexico

**NOTE:** RFB4E-OG for on-grade applications is painted with a fusion-bonded epoxy designed for use on metal reinforcement bar and related accessories before encapsulating in concrete.

**RFB4E, RFB4E-OG Floor Box Compartment Capacities and Knockout Locations and Sizes**

RFB4E & RFB4E-OG COMPARTMENT CAPACITIES	
EACH COMPARTMENT	75 in. <sup>3</sup> (1230ml.)

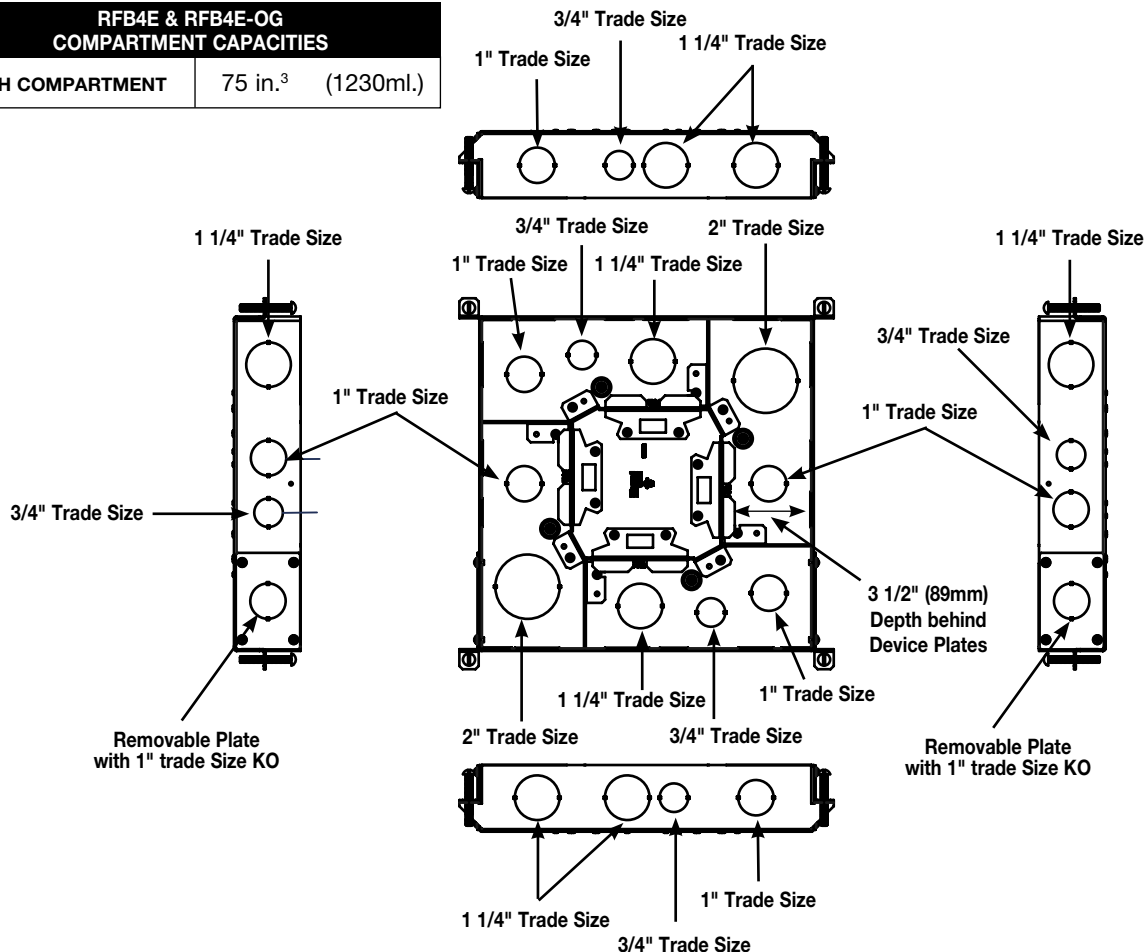

**RFB4E, RFB4E-0G Floor Box Accessories Ordering Information**

**RFB4EKIT**

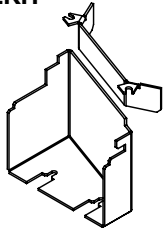

**Barrier Kit** – Barrier kit used to separate power and communication services in combination with a 6CFFTC Furniture Feed Cover. (sold separately).

Country of Origin: Mexico

**RFB6EXT**

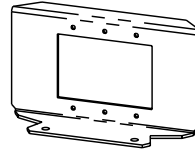

**Internal Audio/Video Bracket** – Accepts three (3) Legrand AVIP or Extron Electronics MAAP Series devices (sold separately).

Country of Origin: USA

**RFB6DP**

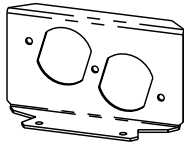

**Internal Duplex Receptacle Bracket** – Accepts standard 15 & 20 Amp duplex receptacles.

Country of Origin: USA

**RFB62A**

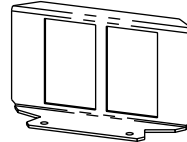

**Internal Communication Bracket** – Includes two (2) adapters to accept Wiremold CM2 Series Open System communication inserts (sold separately).

Country of Origin: USA

**RFB6B**

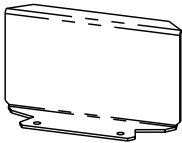

**Internal Blank Bracket** – Closes off unused gangs.

Country of Origin: USA

**RFB6-AAP**

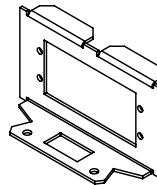

**Internal Audio/Video Bracket** – Accepts two (2) Extron Electronics AAP Series devices (sold separately).

Country of Origin: USA

**RFB6GFI**

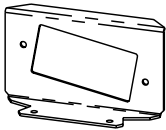

**Internal GFI or Decorator Style Receptacle Bracket** – Accepts standard GFCI & Decorator style receptacles, communication or AV devices.

Country of Origin: USA

**2HUB**

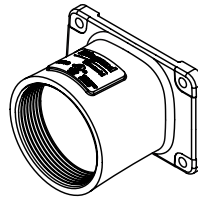

**2" Conduit Transition Hub** – Trade size 2" die cast zinc conduit fitting allows for 2" conduit to transition into a shallow box design. Includes: die cast fitting, gasket, and mounting screws.

Country of Origin: USA

**RFB6S1**

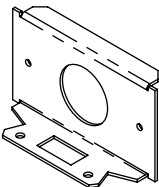

**Internal Single Receptacle Bracket** – Receptacle opening 1 3/8" (35mm).

Country of Origin: USA

**RFB4E-CTR**

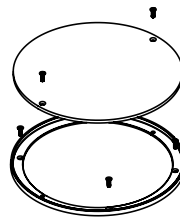

**Bare Concrete & Terrazzo Ring** – Nonmetallic ring for use with bare concrete and terrazzo floor applications.

Country of Origin: USA

**RFB6S2**

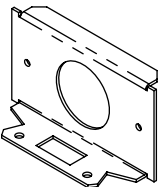

**Internal Single Receptacle Bracket** – Receptacle opening 1 9/16" (40mm).

Country of Origin: USA

**6TS**

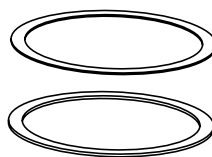

**Tile Shim** – Used for floor coverings greater than 5/16" (7.9mm). The 8TS will allow the top surface of the cover to be flush with the finished floor. Includes: two (2) 1/8" (3.2mm) and two (2) 1/16" (1.6mm) thick shims. Up to a total of 3/8" (9.5mm) of adjustment per pack of tile shims.

Country of Origin: USA

**RFB6RT**

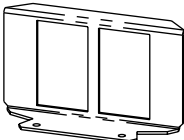

**Internal Communication Bracket** – Includes two (2) adapters to accept Ortronics TracJack devices, and two (2) adapters to accept Ortronics Series II devices (sold separately).

Country of Origin: USA

**Evolution Series Cover Assemblies for RFB2E & RFB4E Floor Boxes Ordering Information**

Catalog No./Item	Description/Specifications	Catalog No./Item	Description/Specifications
6CTC2BK 6CTC2BS 6CTC2GY 6CTC2NK 6CTC2BZ 6CTC2AA 6CTC2SB 6CTC2SN	<p><b>Surface Style Cover Assembly –</b> Low profile cover designed to attach to the 6STC, 6STCP, and 6STCPAV Poke-Thru Stem Assemblies. Each cover is made from die-cast aluminum materials and equipped with a durable hinge which allows the cover to rotate open 180°, two (2) slide egress doors that lock in the open position and auto close around the cables when the covers are closed, an 8° beveled edge that meets ADA guidelines and reduces tripping hazards. These covers are designed to sit on top of finished floor surfaces such as: carpet, tile, wood, polished concrete and terrazzo. Available in five (5) aesthetic powder coated finishes: black (BK), brass (BS), gray (GY), nickel (NK), bronze (BZ), as well as three metal finishes: brushed aluminum (AA), satin brass plated (SB) and satin nickel plated (SN).</p>	6CTC2BKTR 6CTC2BSTR 6CTC2GYTR 6CTC2NKTR 6CTC2BZTR 6CTC2AATR 6CTC2SBTR 6CTC2SNTR	<p><b>Tamper-Resistant Surface Style Cover Assembly –</b> Low profile cover designed to attach to the 6STC, 6STCP, and 6STCPAV Poke-Thru Stem Assemblies. Each cover is made from die-cast aluminum materials and equipped with a tamper-resistant screw to keep out unauthorized personnel, a durable hinge which allows the cover to rotate open 180°, two (2) slide egress doors that lock in the open position and auto close around the cables when the covers are closed, an 8° beveled edge that meets ADA guidelines and reduces tripping hazards. These covers are designed to sit on top of finished floor surfaces such as: carpet, tile, wood, polished concrete and terrazzo. Available in five (5) aesthetic powder coated finishes: black (BK), brass (BS), gray (GY), nickel (NK), bronze (BZ), as well as three metal finishes: brushed aluminum (AA), satin brass plated (SB) and satin nickel plated (SN).</p>

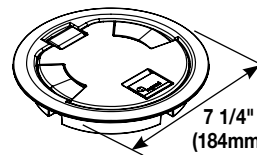
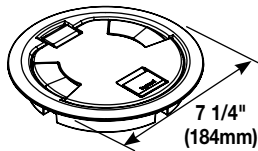

**Country of Origin: India or Mexico**

**Country of Origin: India or Mexico**

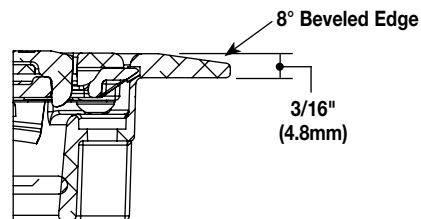
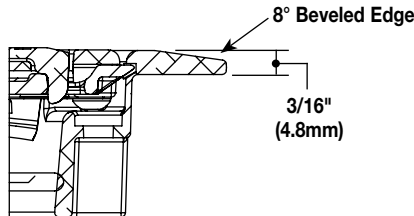

**NOTE: All surface style poke-thru devices come with a transition angle to aid in the change in floor elevation.**

**NOTE: All surface style poke-thru devices come with a transition angle to aid in the change in floor elevation.**

**Evolution Series Cover Assemblies for RFB2E & RFB4E Floor Boxes Ordering Information**

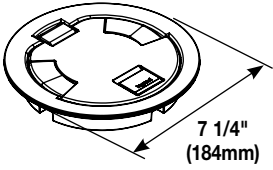
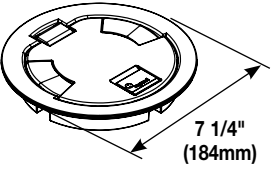
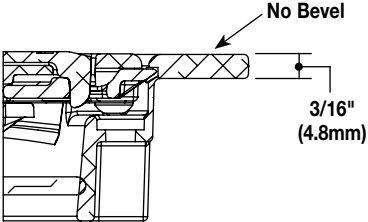
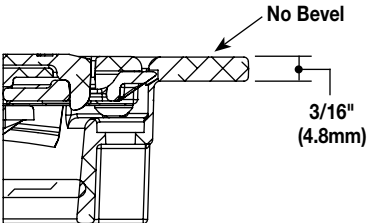
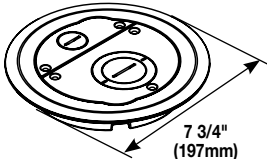
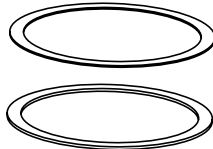
Catalog No./Item	Description/Specifications	Catalog No./Item	Description/Specifications
6CT2BK 6CT2BS 6CT2GY 6CT2NK 6CT2BZ 6CT2AA 6CT2SB 6CT2SN	<p><b>Flush Style Cover Assembly –</b> Low profile covers that are designed to attach to the 6STC, 6STCP, and 6STCPAV Poke-Thru Stem Assemblies. Each cover is made from die-cast aluminum materials and equipped with a durable hinge which allows the cover to rotate open 180°, two (2) slide egress doors that lock in the open position and auto close around the cables when the covers are closed. These covers are designed to sit flush with finished floor coverings such as: carpet, tile, and wood. Available in five (5) aesthetic powder coated finishes: black (BK), brass (BS), gray (GY), nickel (NK), bronze (BZ), as well as three metal finishes: brushed aluminum (AA), satin brass plated (SB) and satin nickel plated (SN).</p> <p><b>Country of Origin: India or Mexico</b></p>	6CT2BKTR 6CT2BSTR 6CT2GYTR 6CT2NKTR 6CT2BZTR 6CT2AATR 6CT2SBTR 6CT2SNTR	<p><b>Tamper-Resistant Flush Style Cover Assembly –</b> Low profile covers that are designed to attach to the 6STC, 6STCP, and 6STCPAV Poke-Thru Stem Assemblies. Each cover is made from die-cast aluminum materials and equipped with a tamper-resistant screw to keep out unauthorized personnel, a durable hinge which allows the cover to rotate open 180°, two (2) slide egress doors that lock in the open position and auto close around the cables when the covers are closed. These covers are designed to sit flush with finished floor coverings such as: carpet, tile, and wood. Available in five (5) aesthetic powder coated finishes: black (BK), brass (BS), gray (GY), nickel (NK), bronze (BZ), as well as three metal finishes: brushed aluminum (AA), satin brass plated (SB) and satin nickel plated (SN).</p> <p><b>Country of Origin: India or Mexico</b></p>
			
			
<p><b>NOTE: Includes 6TS Tile Shim.</b></p>		<p><b>NOTE: Includes 6TS Tile Shim.</b></p>	
6CFFTCBK 6CFFTCBS 6CFFTCGY 6CFFTCNK 6CFFTCBZ 6CFFTCOA	<p><b>Furniture Feed Cover Assembly –</b> Surface style, die-cast aluminum cover assembly, with one (1) 3/4" trade size screw plug opening, and one (1) concentric 2"-1 1/4" trade size screw plug opening. Cover assembly is available in five (5) powder coated finishes: black (BK), gray(GY), nickel (NK), brass (BS), bronze (BZ) and brushed aluminum (AA). 6CFFTC Series Cover Assemblies designed for use with 6STC Poke-Thru Stem Assembly. Includes one (1) 3/4" and one (1) 2" trade size conduit fittings and one (1) divider to separate services.</p> <p><b>Country of Origin: USA</b></p>	6TS	<p><b>Tile Shim –</b> Used for floor coverings greater than 3/16" (4.8mm). The 6TS will allow the top surface of the cover to be flush with the finished floor. Includes: six (6) 1/16" (1.6mm) thick shims. Up to a total of 3/8" (9.5mm) of adjustment.</p> <p><b>Country of Origin: USA</b></p>
			

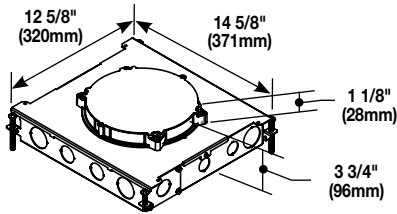

**RFB6E, RFB6E-OG Floor Box Ordering Information**
**RFB6E**

**Six-Compartment Floor Box** – For use in concrete floors. For use with the round Evolution cover. Fully adjustable with tunnel compartments. Supplied with two (2) duplex mounting plates. Other plates sold separately.

Country of Origin: Mexico

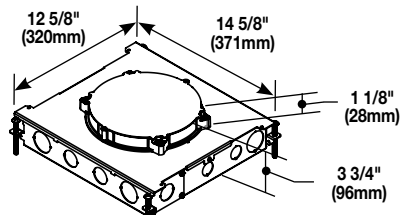
**RFB6E-OG**

**Six-Compartment On-Grade Floor Box** – For use in concrete floors. For use with the round Evolution cover. Fully adjustable with tunnel compartments. Supplied with two (2) duplex mounting plates. Other plates sold separately.

Country of Origin: Mexico

**NOTE:** RFB6E-OG for on-grade applications is painted with a fusion-bonded epoxy designed for use on metal reinforcement bar and related accessories before encapsulating in concrete.

**RFB6E, RFB6E-OG Floor Box Compartment Capacities and Knockout Locations and Sizes**
**COMPARTMENT CAPACITIES**

- A = Power & Data 52 in<sup>3</sup> (852ml)
- B = Power & Data 23 in<sup>3</sup> (376ml)

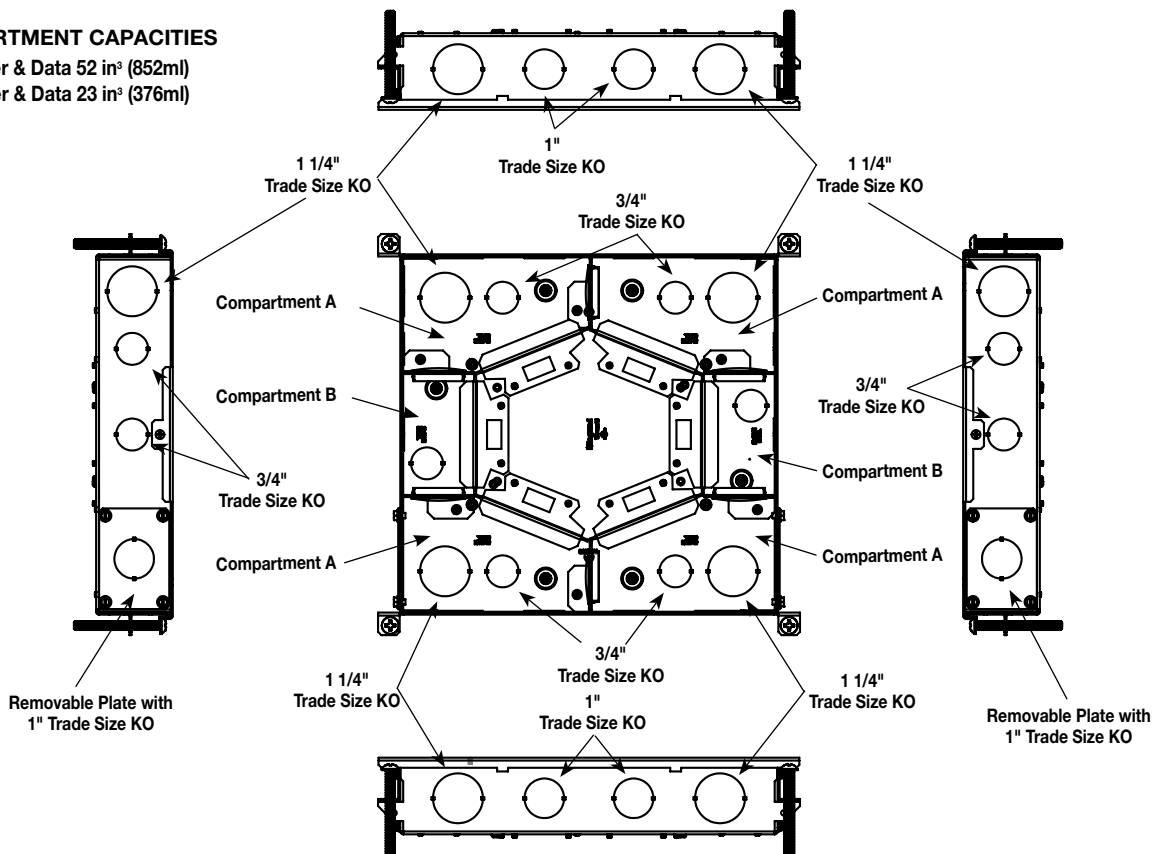

Feed through is accomplished through removable plugs.  
 2" HUB feed through accomplished by removing divider.

**RFB6E, RFB6E-0G Floor Box Accessories Ordering Information**

**RFB6DP**

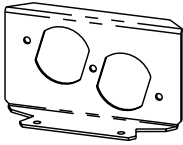

**Internal Duplex Receptacle Bracket** – Accepts standard 15 & 20 Amp duplex receptacles.

**Country of Origin: USA**

**RFB6B**

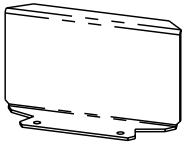

**Internal Blank Bracket** – Closes off unused gangs.

**Country of Origin: USA**

**RFB6GFI**

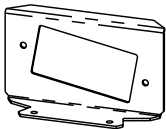

**Internal GFI or Decorator Style Receptacle Bracket** – Accepts standard GFCI & Decorator style receptacles, communication or A/V devices.

**Country of Origin: USA**

**RFB6S1**

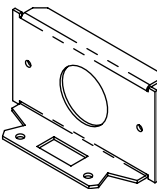

**Internal Single Receptacle Bracket** – Receptacle opening 1 3/8" (35mm).

**Country of Origin: USA**

**RFB6S2**

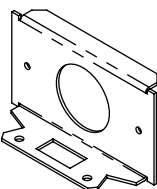

**Internal Single Receptacle Bracket** – Receptacle opening 1 9/16" (40mm).

**Country of Origin: USA**

**RFB6RT**

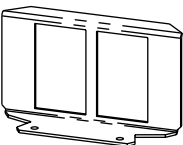

**Internal Communication Bracket** – Includes two (2) adapters to accept Ortronics TracJack devices, and two (2) adapters to accept Ortronics Series II devices (sold separately).

**Country of Origin: USA**

**RFB6EXT**

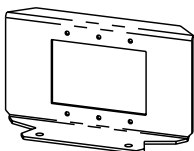

**Internal Audio/Video Bracket** – Accepts three (3) Legrand AVIP or Extron Electronics MAAP Series devices (sold separately).

**Country of Origin: USA**

**RFB62A**

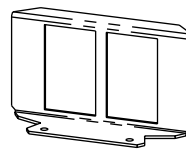

**Internal Communication Bracket** – Includes two (2) adapters to accept Wiremold CM2 Series Open System communication inserts (sold separately).

**Country of Origin: USA**

**RFB6-AAP**

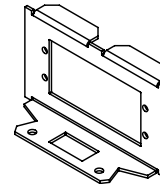

**Internal Audio/Video Bracket** – Accepts two (2) Extron Electronics AAP Series devices (sold separately).

**Country of Origin: USA**

**2HUB**

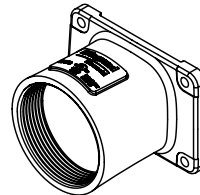

**2" Conduit Transition Hub** – Trade size 2" die cast zinc conduit fitting allows for 2" conduit to transition into a shallow box design. Includes: die cast fitting, gasket, and mounting screws.

**Country of Origin: USA**

**RFB6E-CTR**

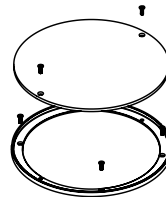

**Bare Concrete & Terrazzo Ring** – Nonmetallic ring for use with bare concrete and terrazzo floor applications.

**Country of Origin: USA**

**8TS**

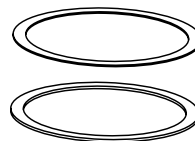

**Tile Shim** – Used for floor coverings greater than 5/16" (7.9mm). The 8TS will allow the top surface of the cover to be flush with the finished floor. Includes: two (2) 1/8" (3.2mm) and two (2) 1/16" (1.6mm) thick shims. Up to a total of 3/8" (9.5mm) of adjustment per pack of tile shims.

**Country of Origin: USA**

**Evolution Series Series Cover Assemblies for RFB6E Series Floor Boxes**

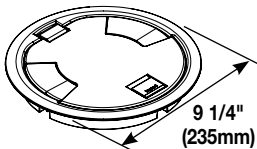
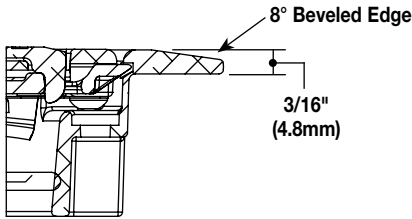
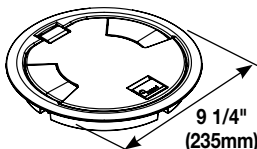
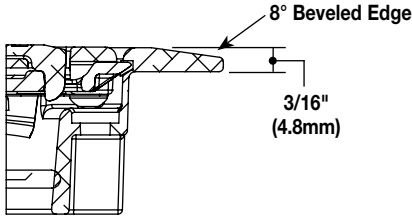
Catalog No./Item	Description/Specifications	Catalog No./Item	Description/Specifications
<p>8CTC2BK 8CTC2BS 8CTC2GY 8CTC2NK 8CTC2BZ 8CTC2AA 8CTC2SB 8CTC2SN</p> 	<p><b>Surface Style Cover Assembly –</b> Low profile cover designed to attach to the 8STC and 8STCP Poke-Thru Stem Assemblies. Each cover is made from die-cast aluminum materials and equipped with a durable hinge which allows the cover to rotate open 180°, two (2) slide egress doors that lock in the open position and auto close around the cables when the covers are closed, an 8° beveled edge that meet ADA guidelines and reduces tripping hazards. These covers are designed to sit on top of the finished floor surfaces such as: carpet, tile, wood, polished concrete and terrazzo. Available in five (5) aesthetic powder coated finishes: black (BK), brass (BS), gray (GY), nickel (NK), bronze (BZ), as well as three metal finishes: brushed aluminum (AA), satin brass plated (SB) and satin nickel plated (SN).</p> <p><b>Country of Origin: India or Mexico</b></p> 	<p>8CTC2BKTR 8CTC2BSTR 8CTC2GYTR 8CTC2NKTR 8CTC2BZTR 8CTC2AATR 8CTC2SBTR 8CTC2SNTR</p> 	<p><b>Tamper-Resistant Surface Style Cover Assembly –</b> Low profile cover designed to attach to the 8STC and 8STCP Poke-Thru Stem Assemblies. Each cover is made from die-cast aluminum materials and equipped with a tamper-resistant screw to keep out unauthorized personnel, a durable hinge which allows the cover to rotate open 180°, two (2) slide egress doors that lock in the open position and auto close around the cables when the covers are closed, an 8° beveled edge that meet ADA guidelines and reduces tripping hazards. These covers are designed to sit on top of the finished floor surfaces such as: carpet, tile, wood, polished concrete and terrazzo. Available in five (5) aesthetic powder coated finishes: black (BK), brass (BS), gray (GY), nickel (NK), bronze (BZ), as well as three metal finishes: brushed aluminum (AA), satin brass plated (SB) and satin nickel plated (SN).</p> <p><b>Country of Origin: India or Mexico</b></p> 
<p><b>NOTE: All surface style poke-thru devices come with a transition angle to aid in the change in floor elevation.</b></p>		<p><b>NOTE: All surface style poke-thru devices come with a transition angle to aid in the change in floor elevation.</b></p>	

**Evolution Series Series Cover Assemblies for RFB6E Series Floor Boxes**

Catalog No./Item	Description/Specifications	Catalog No./Item	Description/Specifications
<b>8CT2BK</b> <b>8CT2BS</b> <b>8CT2GY</b> <b>8CT2NK</b> <b>8CT2BZ</b> <b>8CT2AA</b> <b>8CT2SB</b> <b>8CT2SN</b>	<p><b>Flush Style Cover Assembly –</b> Low profile covers that are designed to attach to the 8STC and 8STCP Poke-Thru Stem Assemblies. Each cover is made from die-cast aluminum materials and equipped with a durable hinge which allows the cover to rotate open 180°, two (2) slide egress doors that lock in the open position and auto close around the cables when the covers are closed. These covers are designed to sit flush with the finished floor surfaces such as: carpet, tile, and wood. Available in five (5) aesthetic powder coated finishes: black (BK), brass (BS), gray (GY), nickel (NK), bronze (BZ), as well as three metal finishes: brushed aluminum (AA), satin brass plated (SB) and satin nickel plated (SN).</p>	<b>8CT2BKTR</b> <b>8CT2BSTR</b> <b>8CT2GYTR</b> <b>8CT2NKTR</b> <b>8CT2BZTR</b> <b>8CT2AATR</b> <b>8CT2SBTR</b> <b>8CT2SNTR</b>	<p><b>Tamper-Resistant Flush Style Cover Assembly –</b> Low profile covers that are designed to attach to the 8STC and 8STCP Poke-Thru Stem Assemblies. Each cover is made from die-cast aluminum materials and equipped with a tamper-resistant screw to keep out unauthorized personnel, a durable hinge which allows the cover to rotate open 180°, two (2) slide egress doors that lock in the open position and auto close around the cables when the covers are closed. These covers are designed to sit flush with the finished floor surfaces such as: carpet, tile, and wood. Available in five (5) aesthetic powder coated finishes: black (BK), brass (BS), gray (GY), nickel (NK), bronze (BZ), as well as three metal finishes: brushed aluminum (AA), satin brass plated (SB) and satin nickel plated (SN).</p>

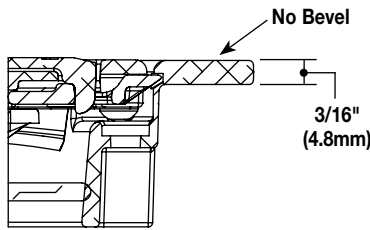
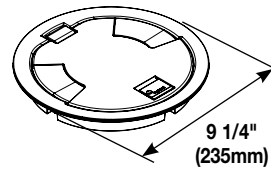
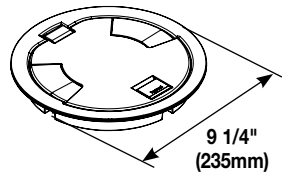

**NOTE:** Includes 8TS Tile Shim.

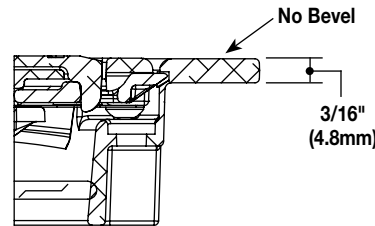

**NOTE:** Includes 8TS Tile Shim.

**NOTE:** All brand and product names referenced in this document are registered trademarks or trademarks of their respective holders.

**NOTE:** The paper used to print this document is an environmentally responsible paper with 10% post consumer waste, with FSC and SFI Chain of Custody certifications, Lacey Act compliant. 100% of the electricity used to manufacture Flo sheets is generated with Green-e certified renewable energy.



**Legrand, North America**  
60 Woodlawn Street  
West Hartford, CT 06110  
1.877.BY.LEGRAND (295.3472)  
www.legrand.us

**Canada**  
905.738.9195  
www.legrand.ca

FOLLOW US

