

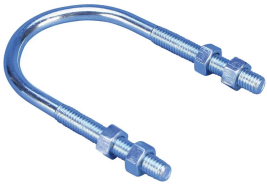

150M STANDARD U-BOLT



FEATURES

Pipe support for general piping applications

Comes complete with 4 nuts (2 installed on each end)

Conforms with Federal Specification WW-H-171 (Type 24), Manufacturers Standardization Society ANSI®/MSS-SP-58 (Type 24)

SPECIFICATIONS

Catalog Number	Material	Finish	Pipe Size	Outer Diameter(OD)	Rod Size(RS)	Screw Length(L)	A	B	Static Load(F)
150M0100EG	Steel	Electrogalvanized	1"	1.315"	1/4"	2 3/8"	3 11/16"	1 9/16"	435 lb
150M0100PL	Steel	Plain	1"	1.315"	1/4"	2 3/8"	3 11/16"	1 9/16"	435 lb
150M0100S4	Stainless Steel 304 (EN 1.4301)		1"	1.315"	1/4"	2 3/8"	3 11/16"	1 9/16"	435 lb
150M0125EG	Steel	Electrogalvanized	1 1/4"	1.660"	3/8"	2 3/8"	4 1/8"	2 1/16"	1,090 lb
150M0125PL	Steel	Plain	1 1/4"	1.660"	3/8"	2 3/8"	4 1/8"	2 1/16"	1,090 lb
150M0125S4	Stainless Steel 304 (EN 1.4301)		1 1/4"	1.660"	3/8"	2 3/8"	4 1/8"	2 1/16"	1,090 lb
150M0150EG	Steel	Electrogalvanized	1 1/2"	1.900"	3/8"	2 1/2"	4 5/16"	2 1/4"	1,090 lb
150M0150PL	Steel	Plain	1 1/2"	1.900"	3/8"	2 1/2"	4 5/16"	2 1/4"	1,090 lb
150M0150S4	Stainless Steel 304 (EN 1.4301)		1 1/2"	1.900"	3/8"	2 1/2"	4 5/16"	2 1/4"	1,090 lb
150M0200EG	Steel	Electrogalvanized	2"	2 3/8"	3/8"	2 1/2"	4 13/16"	2 3/4"	1,090 lb
150M0200PL	Steel	Plain	2"	2 3/8"	3/8"	2 1/2"	4 13/16"	2 3/4"	1,090 lb
150M0200S4	Stainless Steel 304 (EN 1.4301)		2"	2 3/8"	3/8"	2 1/2"	4 13/16"	2 3/4"	1,090 lb
150M0250EG	Steel	Electrogalvanized	2 1/2"	2 7/8"	1/2"	3"	5 3/4"	3 3/8"	2,020 lb
150M0250PL	Steel	Plain	2 1/2"	2 7/8"	1/2"	3"	5 3/4"	3 3/8"	2,020 lb
150M0250S4	Stainless Steel 304 (EN 1.4301)		2 1/2"	2 7/8"	1/2"	3"	5 3/4"	3 3/8"	2,020 lb
150M0300EG	Steel	Electrogalvanized	3"	3 1/2"	1/2"	3"	6 5/16"	4"	2,020 lb
150M0300PL	Steel	Plain	3"	3 1/2"	1/2"	3"	6 5/16"	4"	2,020 lb
150M0300S4	Stainless Steel 304 (EN 1.4301)		3"	3 1/2"	1/2"	3"	6 5/16"	4"	2,020 lb

Catalog Number	Material	Finish	Pipe Size	Outer Diameter(OD)	Rod Size(RS)	Screw Length(L)	A	B	Static Load(F)
150M0400EG	Steel	Electro galvanized	4"	4 1/2"	1/2"	3"	7 5/16"	5"	2,020 lb
150M0400PL	Steel	Plain	4"	4 1/2"	1/2"	3"	7 5/16"	5"	2,020 lb
150M0400S4	Stainless Steel 304 (EN 1.4301)		4"	4 1/2"	1/2"	3"	7 5/16"	5"	2,020 lb
150M0500EG	Steel	Electro galvanized	5"	5 9/16"	1/2"	3"	8 5/16"	6 1/16"	2,020 lb
150M0500PL	Steel	Plain	5"	5 9/16"	1/2"	3"	8 5/16"	6 1/16"	2,020 lb
150M0500S4	Stainless Steel 304 (EN 1.4301)		5"	5 9/16"	1/2"	3"	8 5/16"	6 1/16"	2,020 lb
150M0600EG	Steel	Electro galvanized	6"	6 5/8"	5/8"	3 3/4"	10 1/8"	7 1/4"	3,230 lb
150M0600PL	Steel	Plain	6"	6 5/8"	5/8"	3 3/4"	10 1/8"	7 1/4"	3,230 lb
150M0600S4	Stainless Steel 304 (EN 1.4301)		6"	6 5/8"	5/8"	3 3/4"	10 1/8"	7 1/4"	3,230 lb
150M0800EG	Steel	Electro galvanized	8"	8 5/8"	5/8"	3 3/4"	12 1/8"	9 1/4"	3,230 lb
150M0800PL	Steel	Plain	8"	8 5/8"	5/8"	3 3/4"	12 1/8"	9 1/4"	3,230 lb
150M0800S4	Stainless Steel 304 (EN 1.4301)		8"	8 5/8"	5/8"	3 3/4"	12 1/8"	9 1/4"	3,230 lb
150M1000EG	Steel	Electro galvanized	10"	10 3/4"	3/4"	4"	14 9/16"	11 1/2"	4,830 lb
150M1000PL	Steel	Plain	10"	10 3/4"	3/4"	4"	14 9/16"	11 1/2"	4,830 lb
150M1000S4	Stainless Steel 304 (EN 1.4301)		10"	10 3/4"	3/4"	4"	14 9/16"	11 1/2"	4,830 lb
150M1200EG	Steel	Electro galvanized	12"	12 3/4"	7/8"	4 1/4"	16 15/16"	13 5/8"	6,730 lb
150M1200PL	Steel	Plain	12"	12 3/4"	7/8"	4 1/4"	16 15/16"	13 5/8"	6,730 lb
150M1200S4	Stainless Steel 304 (EN 1.4301)		12"	12 3/4"	7/8"	4 1/4"	16 15/16"	13 5/8"	6,730 lb

DIAGRAMS

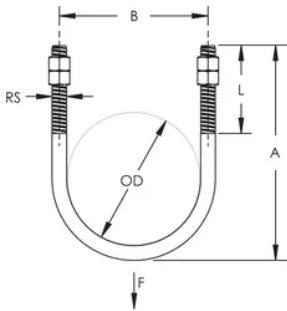

WARNING

nVent products shall be installed and used only as indicated in nVent's product instruction sheets and training materials. Instruction sheets are available at www.nvent.com and from your nVent customer service representative. Improper installation, misuse, misapplication or other failure to completely follow nVent's instructions and warnings may cause product malfunction, property damage, serious bodily injury and death and/or void your warranty.

North America

+1.800.753.9221

Option 1 – Customer Care

Option 2 – Technical Support

Europe

Netherlands:

+31 800-0200135

France:

+33 800 901 793

Europe

Germany:

800 1890272

Other Countries:

+31 13 5835404

APAC

Shanghai:

+ 86 21 2412 1618/19

Sydney:

+61 2 9751 8500



Our powerful portfolio of brands:
nVent.com CADDY ERICO HOFFMAN RAYCHEM SCHROFF
TRACER